

TOTEM

Discover yours

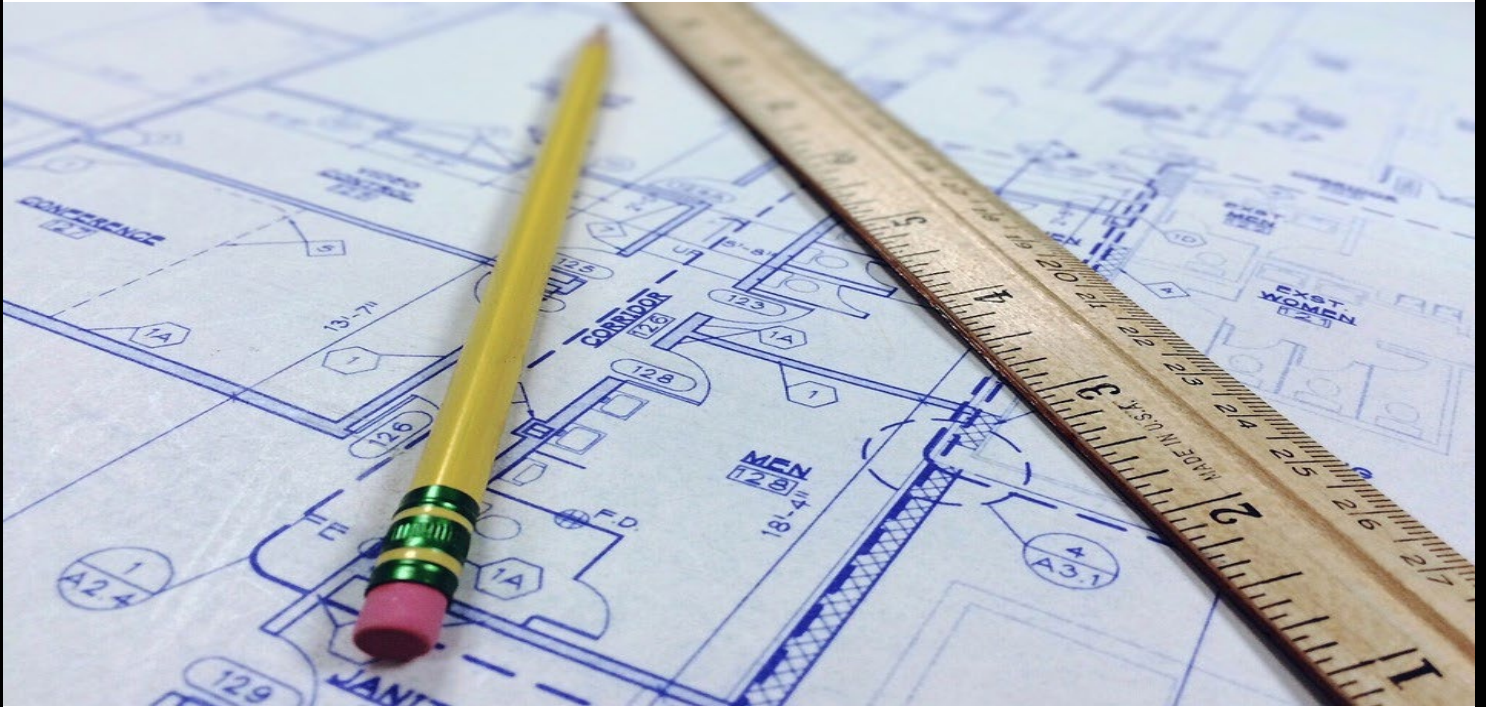

Tribe

Architectural Series Manual
Angled In-Ceiling / LCR / In-Wall

TRIBE ARCHITECTURAL MANUAL

Thank you for choosing the Totem Acoustic Tribe Architectural series.

Please take the time to fully read this manual prior to beginning set-up. The manual will clearly guide you to achieve the best possible sound that these newly acquired Totem speakers can provide.

Beyond sonic performance, Totem has given tremendous consideration to the home integrator. New construction or retrofit, the TRIBE Architectural speakers are easy to install and their integrated back box ensures consistent performance in almost every situation and application.

For further assistance, contact our tech support at info@totemacoustic.com.

UNPACKING

Totem Acoustic keeps to a strict quality control regimen and all factory-sealed products leave our facility in perfect condition. If there are any damages visible or concealed that has occurred in handling it must be reported immediately to your Totem Authorized Dealer.

Carefully remove the speaker(s) from the box(es). Save all custom cartons and packaging foam for future use. They are rather expensive and may come in handy for future upgrades.

CONTENTS

Each individual box contains:
1 TRIBE Architectural speaker,
1 stainless steel, magnetic grill,
1 cutout template.

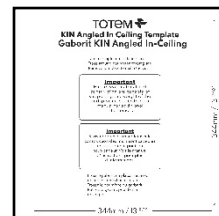

TOOLS AND ITEMS REQUIRED

- Drywall saw
- Speaker wire
- Wire stripper
- Pencil
- Drill
- Stud Finder
- Measuring Tape
- Metal hanger
- Fish tool
- Spray paint-optional



GENERAL SPEAKER PLACEMENT GUIDELINES

Totem TRIBE Architectural series diffuse sound in an enormously wide, expansive manner comparable to a flood light and illuminate a room with Totem’s holographic sound whereas most others function like a focused, narrow spotlight, creating small, limited, acoustic “hot spots”.

TRIBE Architectural custom speakers disperse at 75 degrees, almost twice as broadly as competitive speakers. The soundstage and acoustic coverage is totally present throughout the entire listening area, so it takes fewer Totem speakers to thoroughly fill a room than competitive brands and interamalgamate with greater ease. In-walls create a soundstage with remarkable height and width, often beyond the boundaries of the room itself. The enormous dispersion of the in-ceilings allows the listener to enjoy the same sound whether a seated or standing, simplifying placement.

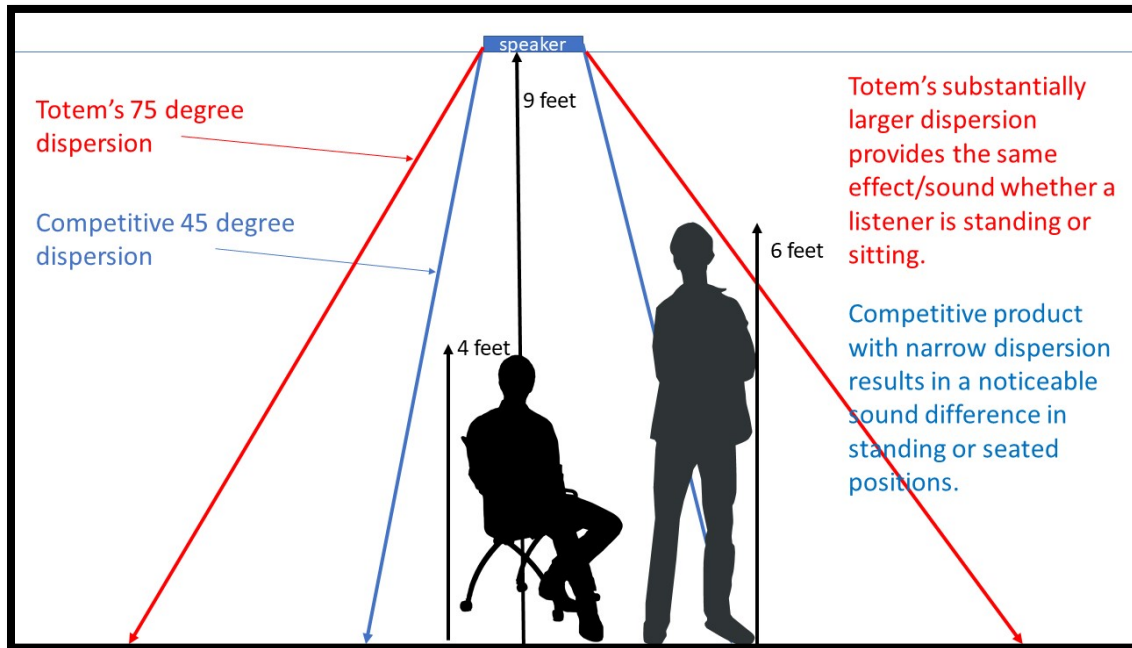

The following chart for in-ceiling speaker spacing was calculated using the following formula:
 $ANGLE \text{ (dispersion)} \times .018 \times DISTANCE \text{ (ceiling height)} = \text{SOUND COVERAGE radius}$

Ceiling Height	Distance Apart	
	Feet	Meters
8ft Ceiling	10.8	3.29
9ft Ceiling	12.15	3.7
10ft Ceiling	13.5	4.11
12ft Ceiling	16.2	4.93
14ft ceiling	18.9	5.76
15ft Ceiling	20.25	6.17

RECOMMENDED SPEAKER WIRE

Length of Run	Suggested Wire Gauge
Up to 75 feet / 22.86 meters	16 gauge
75-200 feet / 22.86 to 60.96 meters	14 gauge
Over 200 feet / over 60.96 meters	12 gauge

PRECAUTIONS BEFORE INSTALLATION

Check for obstructions. Use an electronic stud finder to check for ceiling joists, heating and ventilating shafts, or wall studs that may hinder cutting the required opening or the running of the cable to your desired location.

In order to ensure proper hole size, attach the cutout template and drill a hole in the center of the outline. Cut approximately 1' (30cm) of coat hanger wire and bend it to a right angle in the middle. Insert in the hole and rotate to check for wires, pipes, studs or other obstructions.

GENERAL PLACEMENT GUIDELINES

Always bear in mind that corner locations cause acoustic directionality, limit dispersion and emphasize low frequencies.

IN WALL PLACEMENT

When using in-wall speakers as main channels, optimal sound will be achieved when they are mounted at or slightly above ear level. The listening distance should be no closer than the distance between the speakers themselves. If they are used as surround channels, typical placement is adjacent and behind the listener at a height of approximately 6 feet.

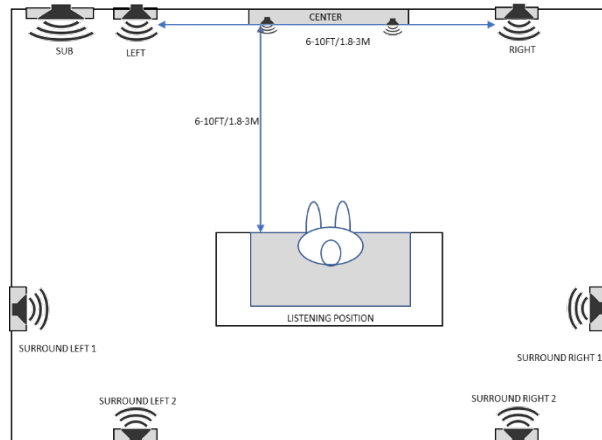

STEREO AUDIO APPLICATIONS

When a pair of TRIBE Architectural Series speakers are used for conventional stereo reproduction, OR in conjunction with a TV, they should be placed in front and adjacent to the TV. Whenever possible, leave some distance from rear and side wall boundaries.

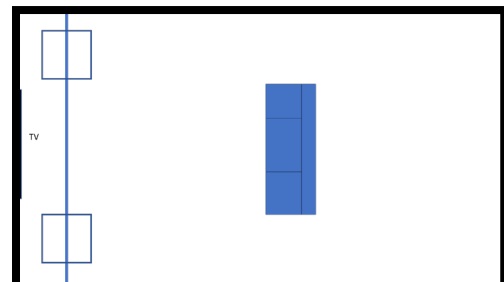

MULTI-CHANNEL AUDIO / HOME THEATER APPLICATIONS

In a 5.1 set up, the Left, Center, and Right should be along the same plane with the Left and Right Surround in back and adjacent to the sitting area.

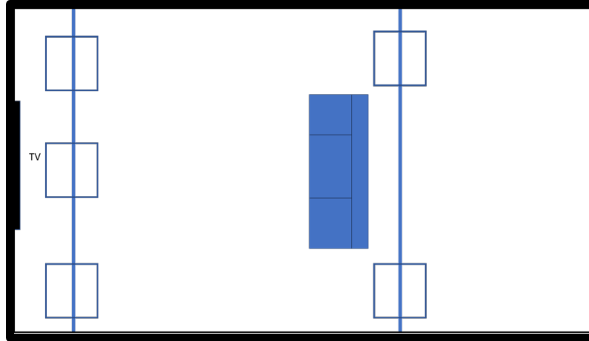

5.1

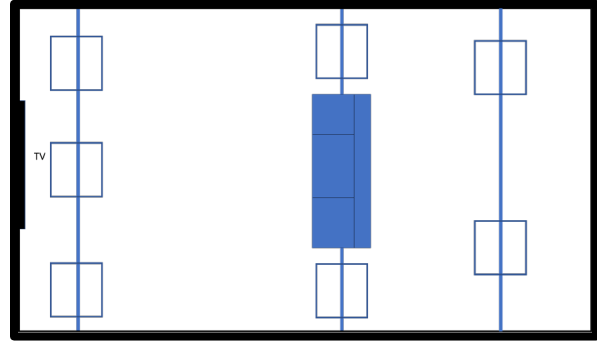

7.1

In a 7.1 set up, the Left, Center, and Right should be along the same plane with the Left and Right Surround parallel to the listening area, and the Surround channels in back and adjacent to the sitting area.

If using in-wall speakers, the spacing is accurate, but the speakers would be installed in the wall. In the case of the 7.1 system, the rear speakers can also be installed into the rear wall.

True to both Totem and TRIBE heritage, all models possess our characteristic phase linearity for uncanny realism, a full range response for truly dynamic performance, and remarkably huge dispersion that facilitates placement and fills the room. They can also intermix harmoniously with any existing traditional, on-wall, or architectural Totem speaker for a variety of multi-channel options. For example, if you are using TRIBE On-Wall speakers for your front three channels you can seamlessly blend Kin Architectural for your rear speakers.

MULTI-CHANNEL AUDIO / HOME THEATER APPLICATIONS

Positioning the Angled In-Ceiling Speaker

The TRIBE AIC is composed of three active drivers on one portion of the angled baffle, and two passives on the other. The active drivers should be directed towards the listening area for the most direct signal and best overall performance.

This generally means the portion with active drivers are positioned closest to the wall and angled towards the listening area. The passives are positioned closer to the listening area with the drivers towards the wall.

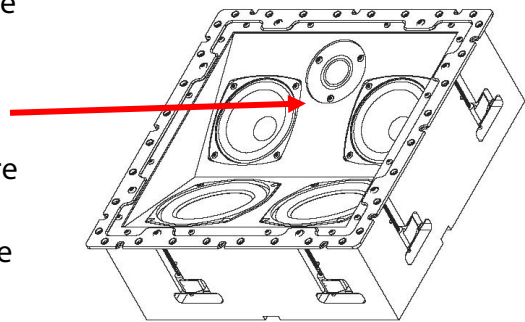

INSTALLATION

1-Use the provided template to trace a rectangle in pencil for the intended location. **TIP:** Make a small hole in the center of the outline. Use approximately 1' (30cm) of coat hanger wire and bend it to a right angle in the middle. Insert in the hole and rotate to check for wires, pipes, studs or other obstructions.

2-Carefully cut out the speaker cavity with a drywall saw or similar tool. Remove the cutaway and lightly compress the insulation, if any.

3-Fish the speaker cable from the amplifier and out through the recently cut speaker cavity. Allow yourself at least 1' (30cm) of slack to protrude to facilitate the installation. Strip 3/8" (1cm) off the ends of the speaker wires and connect to the speaker terminals. **Note:** Make sure to respect polarity of the wire, connecting the negative and positive leads to the right inputs.



4-Ensure the "Dog Ears" are in their original position, flush set within the frame, and insert the speaker in the wall or ceiling. Gradually tighten the Philips screws on the speaker frame to fix the speaker in place. They can handle strong torque settings, but ideally lower torque setting should be used to prevent accidents and ensure a proper installation. Textured terminals provide extra grip on any material, guaranteeing a solid, tight installation.

5- Place grille on speakers to complete the installation.



PAINTING THE GRILLS

The stainless steel grilles can be painted to suit personal tastes and match aspects of the décor. The grill incorporates a scrim-cloth to hide the drivers when installed. This scrim-cloth is adhered to the grill with a light adhesive and must be removed before painting but maintains its adhesion qualities and will reattach once painted. To remove it, gently peel from the small tab inconspicuously located along the trim. Ideally the process would be done with spray paint or a spray gun set to a low setting which lessens the chance of plugging the holes. After the paint is dry, re-apply the scrim-cloth.



OPTIONAL ACCESSORIES

preconstruction kits are available for all models.

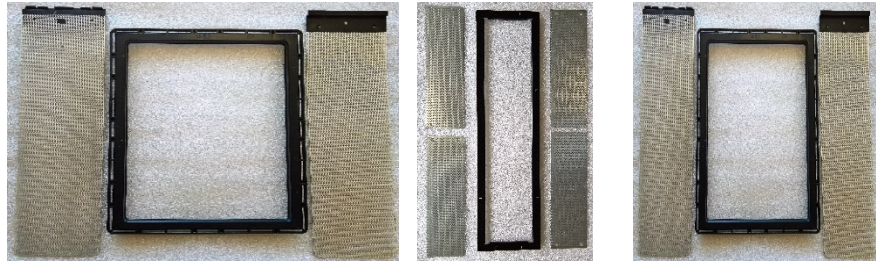

AIC

LCR

IW

SPECIFICATIONS

Specification	TRIBE Angled In Ceiling	TRIBE LCR	TRIBE IW
Design	Full back-boxed, high-performance loudspeaker	Full back-boxed, high-performance loudspeaker	Full back-boxed, high-performance loudspeaker
Frequency Response:	47 Hz - 30 kHz \pm 3 dB	50 Hz - 30 kHz \pm 3 dB	60 Hz - 30 kHz \pm 3 dB
Recommended Power:	30 - 140 W	30 - 140 W	30 - 140 W
Woofer:	Twin 4"/10cm Neodymium Actuated, Enriched MHEX woofers with High Excursion Surrounds in Outsized Cast Baskets	Twin 4"/10cm Neodymium Actuated, Enriched MHEX woofers with High Excursion Surrounds in Outsized Cast Baskets	Twin 4"/10cm Neodymium Actuated, Enriched MHEX woofers with High Excursion Surrounds in Outsized Cast Baskets
Passive Radiators	Dual 5" Metal Amalgamation Compound	Dual 5" Metal Amalgamation Compound	
Tweeter:	Huge 1 1/8"/29mm Soft Dome	Huge 1 1/8"/29mm Soft Dome	Huge 1 1/8"/29mm Soft Dome
Impedance:	6 ohms	6 ohms	6 ohms
Sensitivity	90 dB	90 dB	90 dB
Dimensions (W x H x D):	14.09" x 14.09" x 6 1/8" / 358 x 358 x 155 mm	7.09" x 25.51" x 3.75" / 180 x 648 x 95.25mm	15.27" x 7.09" x 3.75" / 388 x 180 x 95.25mm
Cutout	13.38 x 13.38 / 340 x 340mm	6.37" x 24.8" / 161.8 x 630mm	14.56" x 6.37" / 370 x 161.8mm
Grill Type	Magnetic, Paintable, virtually bezel-less white metal	Magnetic, Paintable, virtually bezel-less white metal	Magnetic, Paintable, virtually bezel-less white metal
accessories	Pre-Construction Brackets	Pre-Construction Brackets	Pre-Construction Brackets

TOTEM LIMITED WARRANTY

Totem speakers must be purchased from a TOTEM AUTHORIZED DEALER.

Keep your original bill or receipt obtained from your Totem Authorized Dealer. Retain the sturdy carton and all packing material; if needed, it will prove invaluable for damage-free transport or storage and upgrade purposes.

All Totem products are created with the utmost care and quality in mind. If ever a problem should arise, Totem Architectural speakers are covered by a five (5) year limited warranty, starting from the date of purchase. The Totem limited warranty applies to products in normal home use only.

The warranty is void if serial numbers have been altered or removed. The warranty is void if products have been tampered with or show signs of abuse.

The warranty on speakers is void if the voice coils are burned or damaged as a result of overpowering or clipping.

The speakers require at least 75-100 hours of actual music playing time as a minimal break-in period. During this time, refrain from playing them at very loud levels. You will notice a definite gradual improvement in the cohesiveness of the music reproduction as this occurs.

REGISTRATION

We would very much appreciate if you took the time to register your product online. Product registration leads to quicker assistance and more efficient support in the rare case that your speaker should have a problem. This can be done quickly and easily in the support section of our site:

<https://totemacoustic.com/register-your-product/>

If you require additional information or further assistance on the Totem you've discovered, contact your TOTEM AUTHORIZED DEALER or visit the warranty section of the Totem website at:

<https://totemacoustic.com/warranty/>

Follow and Like us on Facebook:

<https://www.facebook.com/totemacoustic/>



We reserve the right to any future change or modification without notice.

For further assistance, contact your TOTEM AUTHORIZED DEALER or visit the Totem website at www.totemacoustic.com